

INSTALLATION MANUAL

Tiger IP69K LED Batten - Food Grade - 36W - 1200mm



Electrical Characteristics

Voltage: 220-240V AC 50/60Hz
 36W @ 130 lm/W PF: ≥0.90 THD <20%
 Power Efficiency :≥ 0.87

General Characteristics

Rated IP69K for high temperature washdowns
 4700 lumens 5000K Natural White
 Stainless steel & PMMA construction
 3 year warranty

Temperature Characteristics, Ta 25 °C

Operating -20~+40 °C Storage -40~+85 °C

IMPORTANT

Please read this instruction manual carefully before installing the battens.

The light fittings should be installed, connected and tested by a certified installer based on local regulations.

Please check voltage in accordance with the product requirements before using the product.

Relamping only can be done when the power is off and the lamp has completely cooled down.

When a lamp is to be cleaned, turn the power off and let it cool down completely.

Clean the fixture with a soft cloth and a standard PH neutral detergent.

Stainless steel finish should be maintained regularly.

Misuse of, or changes to the fixture shall nullify the guarantee.

Do not cover the fixtures with flammable materials.

1. Product Dimensions

70mm
Diameter

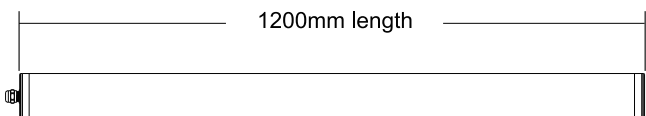

2. Accessories

Standard accessories included



Metal Bracket
 One package two pcs



Screw
 One package two pcs

Optional suspension kit



Steel cable
 One package two pcs

3. Installation procedures

A. Ceiling-mounted (standard installation)

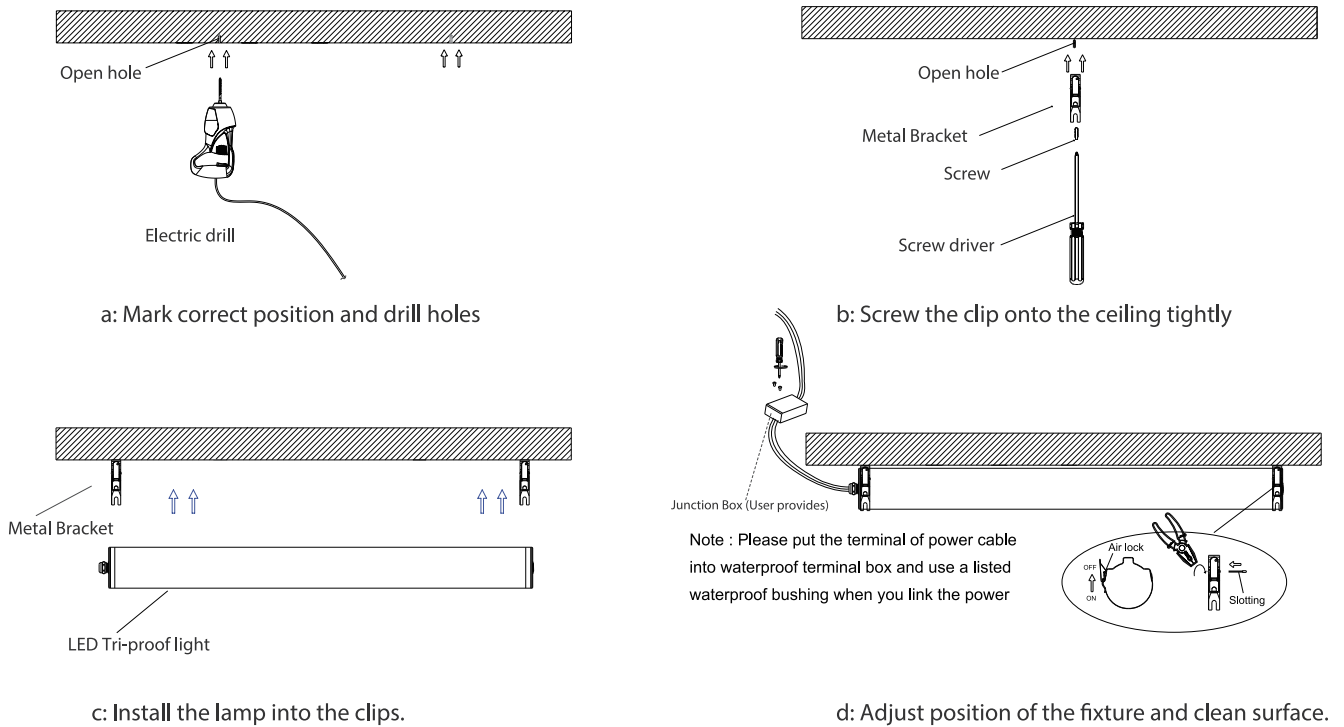

B. Suspended from ceiling (NB Accessories required)

