

LED AREA LIGHT

MAKO Area Light

30W 40W 50W

30W	4,120 lm	40W	5,500 lm	50W	6,820 lm
-----	----------	-----	----------	-----	----------

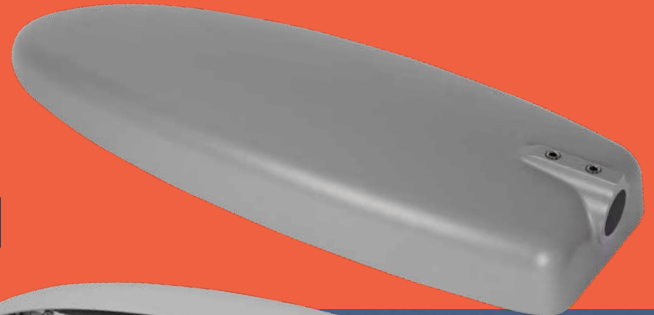

High-performance industrial area light
Maximum light spread from low mounting heights 2.4m+
Multi-purpose - conveyor & gantry lighting to private roadways
Rated IP67 and IK10 to handle the toughest environments.



-140 LUMENS
PER WATT



T2M LENSES
& OPTIONS



IP67
RATING



IK10
RATING



EMERGENCY
OPTIONS



GREEN & AMBER
LED OPTIONS



5 YEAR
WARRANTY

SLEEK MODULAR DESIGN AND HIGHEST QUALITY COMPONENTS

Heavy duty industrial area light
Sleek design to prevent build up of dust and dirt
Wide light spread to suit shorter poles 2.4 to 6m
Driver switchable between 30W, 40W and 50W
Output approx 140 lm/W
Operating temperatures of -40 to +50°C
Rated IP67 and IK10
Polycarbonate lenses. No glass
34mm spigot entry
5 years warranty. 3 years for Emergency Mako.

APPLICATIONS

- Sleek design suits general streetlighting tasks at low mounting heights of 4 to 6m
- Low cost area lighting around industrial plants, mining camps, outbuildings, storage yards, muster points, access gates, roads & tracks
- Task lighting over plant & equipment, conveyors & gantries, typically with 2.4-3m mounting height
- Emergency option for emergency applications
- Emergency shower and eyewash stations.



DESIGNED FOR MAXIMUM LIGHT SPREAD FROM LOW MOUNTING HEIGHTS FROM 2.4 M.
CONVEYORS • GANTRIES • WALKWAYS • PERIMETERS • ROADWAYS

Sleek design with rounded surfaces to prevent build-up of soil or caustic materials

34mm spigot entry, secured by two stainless steel bolts

Polyester coated (min 100 microns), cast aluminium housing

LED module with polycarbonate lenses. No glass in the fitting. Rated IK10



Super-reliable Philips Xitanium driver
Driver output switchable between 30W, 40W and 50W
[50W option not available for Emergency]



High-efficiency LED chips producing ~140 lumens/Watt

IP67-rated to handle wet and dusty environments. (Emergency Mako is IP66)

T2M lenses for wide batwing light distribution (Other options including T3M, T4S & T4M also available)

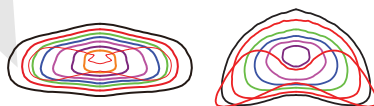

10kVA surge protection

Operating temperatures of -40 to +50°C for extreme conditions

Switchable from 40W (standard) down to 30W or up to 50W to suit lux requirements
[Emergency lights 30W & 40W only]

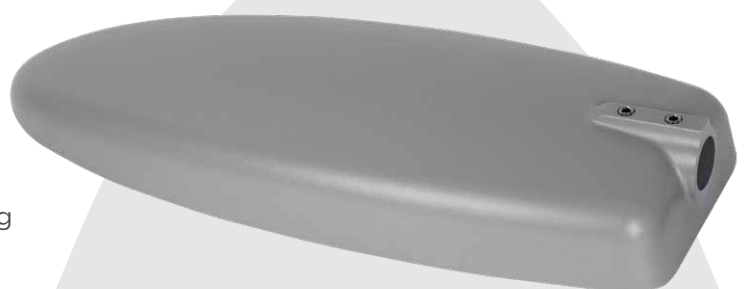

APPLICATIONS

GANTRY/CONVEYOR LIGHTING
MOUNTING HEIGHT BETWEEN 2.4 AND 3.0M

30W MAKO



BRIGHTNESS & UNIFORMITY

High output fitting @ 140+ lumens/W
Wide beam at low mounting heights - T2M lenses

RELIABILITY

Proven quality components
Heavy duty construction

LONGEVITY

Operating temperatures -40 to +50°C
Vibration-proof. IP67 and IK10.



LIGHTING STANDARD

GANTRY/CONVEYOR LIGHTING
30W MAKO AREA LIGHT WITH T2M LENSES
MOUNTING HEIGHT BETWEEN 2.4 AND 3.0M
Standard 40 lux ave. LLF 0.7

Mounting height	Ave lux	Max Lux	Min lux	Spacing
2.4m	55	110	21	14m
2.7m	50	120	16	16m
3.0m	49	98	19	16m

APPLICATIONS

ROADWAY / COMMUNITY LIGHTING MOUNTING HEIGHTS TO 6M

30/40/50W MAKO

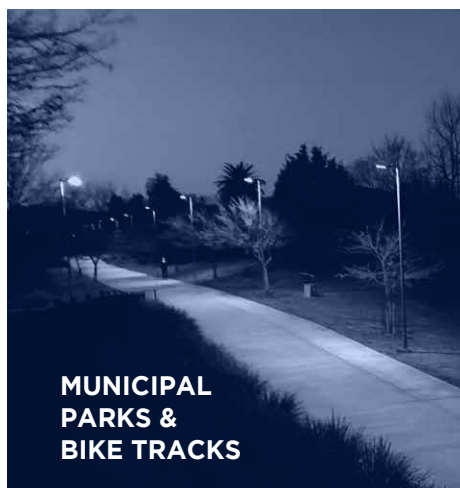

**MUNICIPAL
PARKS &
BIKE TRACKS**

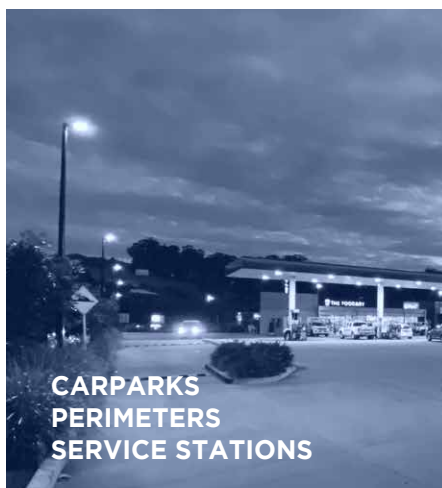

**CARPARKS
PERIMETERS
SERVICE STATIONS**



**MINING CAMPS &
CARAVAN PARKS**

ROADWAY / COMMUNITY LIGHTING

40W MAKO AREA LIGHT WITH T2M LENSES
MOUNTING HEIGHTS FROM 4M TO 6M

Beam area >1 lux. LLF 0.8

Mounting Height	Ave Lux	Max Lux	Beam Area
4m	14	86	32x13m
5m	11	56	37x16m
6m	8	38	41x 18m

HOUSING COLOUR OPTIONS

Standard colour is grey
(Colour RAL 7004).
Black is also available
to suit black poles.

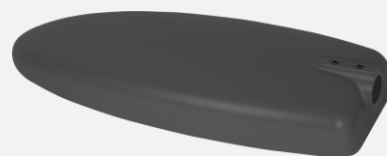

OPTIONAL LIGHTING CONTROLS

- **MICROWAVE MOTION SENSOR**
Dimmable 1-10VDC for auto-dimming
when unattended.
Remote control programming.
- **PE CELL**
Auto on-off for operation between
dusk and dawn



**MICROWAVE
MOTION SENSOR**
1-10VDC dimming
programmable
by remote control

PE CELL
Light sensor
with protective
metal shield

VOLTAGE OPTIONS

100-277VAC is standard voltage.
12VDC option is also available.

OPTIONS

EMERGENCY MAKO



Maintained emergency fitting Battery in driver compartment 40W - 5400 lm. IP66.

3 hours 5W emergency runtime
Status indicator light/test button underneath
Emergency Mako is rated IP66
3 yr warranty.

SPECIFICATIONS - MAINTAINED EMERGENCY OPTION

Battery located inside driver compartment
5W emergency output - 3 hour runtime.

Operating mode	Maintained
Charging method	Intelligent current limited constant voltage
Testing system	Status light & test switch under fitting
Cable connector	4 core cable with 4 position terminal block Constant active, switched active, neutral, earth
Operating temp	0-40°C
IP Rating	IP66
NB 50W driver output option not available for Emergency lights.	



EMERGENCY SHOWER EYEWASH STATION



Safety shower & eyewash stations Green LED chipset (530nm) 40W - 5,500 lm Built-in 5W emergency pack 3 hour battery back-up.

Long 50,000 hrs service life.
Wide beam spread for greatly improved
visibility in emergency situations.
IP66. 3 year warranty.



AMBER OUTPUT

Amber LED - turtle friendly 595nm LED chipset 30W, 40W, 50W nominal.

For areas above the Tropic of Capricorn where
turtle-friendly lighting is prescribed.
Or for extremely dusty or foggy conditions requiring
improved visibility.



OPTIONAL WALL-BRACKET

Optional 304 stainless steel bracket with short spigot available for mounting onto walls (PART NUMBER - SAMAKOBT).



DIMENSIONS

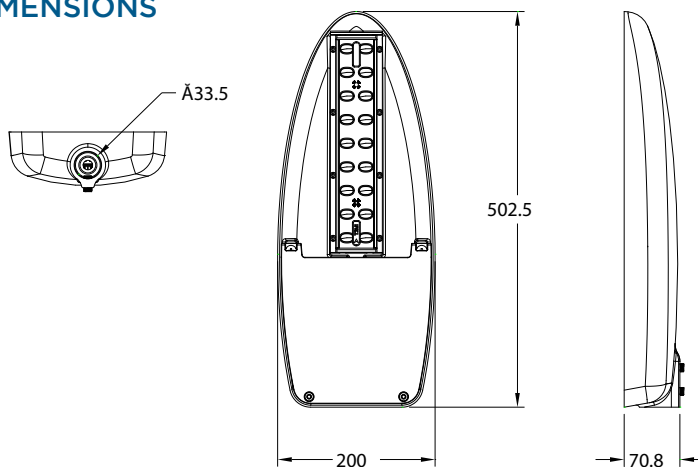

SIZE: 495mm L x 200mm W x 75mm H
WEIGHT: 5.88kg
EPA: 0.076m²

OPTICAL LENS OPTIONS

Asymmetric:
T2M is the standard lens specification.
T3M, T4S and T4M are also available.

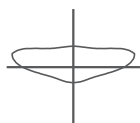

T2M

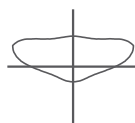

T3M

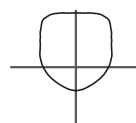

T4S

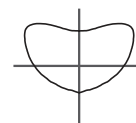

T4M

DELIVERY OF MADE-TO-ORDER ITEMS

Please allow up to 6-8 weeks for special order items and where sufficient components may not be available locally.

TECHNICAL PARAMETERS

Power consumption	30W, 40W, 50W (nominal, via switch on driver)
Input voltage options	100-277VAC (12VDC option also available)
LED chip drive current	30W - 530mA, 40W - 700mA, 50W - 875mA
Power factor	≥0.9 at full load
Surge protection	Imax 10kA
LED chips	High performance -140+ lm/W
Driver / Dimming	Philips Xitanium / Dimmable 1-10VDC
Luminous flux	30W - 4120 lm, 40W - 5500 lm, 50W - 6820 lm
Colour temperature	5000°K (options for Amber, 4000°K, 6000°K, Green)
CRI	RA >70
Light distribution	IESNA T2M standard. T3M, T4S, T4M options
IP Rating / IK Rating	IP67 / IK10

Composition - lenses	Polycarbonate - no glass
Composition - housing	Aluminium with polyester coating (>100 microns)
Exterior colour	Grey-RAL7004 or black. Orange panel (Emergency)
Spigot entry diameter	34mm spigot entry
Weight / Dimensions / EPA	5.88kg / 495 L x 200 W x 75mm H / 0.076m ²
Working temperature	-40 to 50 °C
Service life	>50,000 hours
Warranty	5 years. 3 years for emergency fittings
Product code 30/40W/50W	SL040MAKO SL040MAKO-AM (Amber CCT)
With sensors	SL040MAKO-PE (PE) SL040MAKO-MMS (microwave)
Emergency	SL040MAKO-EM
Green Emergency	SL040MAKO-EMG
Stainless wall bracket	SLMAKOBKT